

SCHEDULE OF EXISTING TREES

KEY	BOTANICAL NAME	COMMON NAME	HEIGHT X SPREAD
1.	<i>Angophora costata</i>	Sydney Red Gum	25 x 14m
2.	<i>Quercus robur</i>	English Oak	11 x 10m
3.	<i>Melaleuca saligna</i>	Paper Bark	8 x 8m
4.	<i>Melia azedarach</i>	White Cedar	5 x 6m
5.	<i>Acacia binervia</i>	Wattle	12 x 8m
6.	<i>Acacia binervia</i>	Wattle	9 x 6m
7.	<i>Acacia binervia</i>	Wattle	5 x 4m
8.	<i>Angophora costata</i>	Sydney Red Gum	14 x 8m
9.	<i>Eucalyptus globioidea</i>	White Stringy Bark	11 x 8m
10.	<i>Erythrina cristagalli</i>	Cockspur Coral Tree	10 x 10m

NOTE: Also refer to Arborist Impact Statement prepared by Bradshaw Tree Services dated 12th October 2018.

SCHEDULE OF PLANT MATERIAL

CODE	BOTANICAL NAME	COMMON NAME	QUANTITY	MATURE HEIGHT	CONTAINER SIZE	STAKES
AAm	<i>Acmena smithii</i> 'Allyn Magic'	Dwarf Lilli Pilli	65	1m	200mm	-
AC	<i>Angophora costata</i>	Sydney Red Gum	2	25m	75 litre	2
BSp	<i>Banksia spinulosa</i>	Hairpin Banksia	27	1.5m	200mm	-
DC	<i>Dianella caerulea</i>	Paroo Lily	58	0.4m	140mm	-
DClj	<i>Dianella caerulea</i> 'Little Jess'	Little Jess Dianella	218	0.4m	140mm	-
Dlr	<i>Dianella revoluta</i> 'Little Rev'	Little Rev Dianella	53	0.3m	140mm	-
EH	<i>Eucalyptus haemastoma</i>	Scribbly Gum	5	20m	75 litre	2
ER	<i>Elaeocarpus reticulatus</i>	Blueberry Ash	2	5m	75 litre	2
HV	<i>Hardenbergia violacea</i>	Native Sarsparilla	180	prostrate	140mm	-
LLt	<i>Lomandra longifolia</i> 'Tanika'	Tanika Lomandra	181	0.4m	140mm	-
LN	<i>Lomandra 'Nyalla'</i>	Nyalla Lomandra	96	0.4m	140mm	-
LS	<i>Lomandra 'Seascape'</i>	Seascape Lomandra	38	0.4m	140mm	-
TL	<i>Tristaniopsis laurina</i> 'Luscious'	Water Gum	14	5m	75 litre	2
WAb	<i>Westringia 'Aussie Box'</i>	Dwarf Coastal Rosemary	41	1m	200mm	-
WF	<i>Waterhousea floribunda</i>	Weeping Lillypilly	4	15m	200 litre	2

The plants in this schedule have been selected from a list of 'Australian Plants for Fire Prone Areas' from the Australian Native Plant Society and other know low flammability species.

LEGEND

- EXISTING LEVELS
- EXISTING TREES TO BE RETAINED
- NEW CONCRETE PAVING. REFER TO ARCHITECTS DETAILS.
- NEW COLOURED CONCRETE PAVING. REFER TO ARCHITECTS DETAILS.
- NEW TURF AREAS
- PROPOSED TREES
- PROPOSED SHRUB PLANTING
- PROPOSED MASS PLANTED
- GROUNDCOVERS/NATIVE
- GRASSES
- BRICK GARDEN EDGING

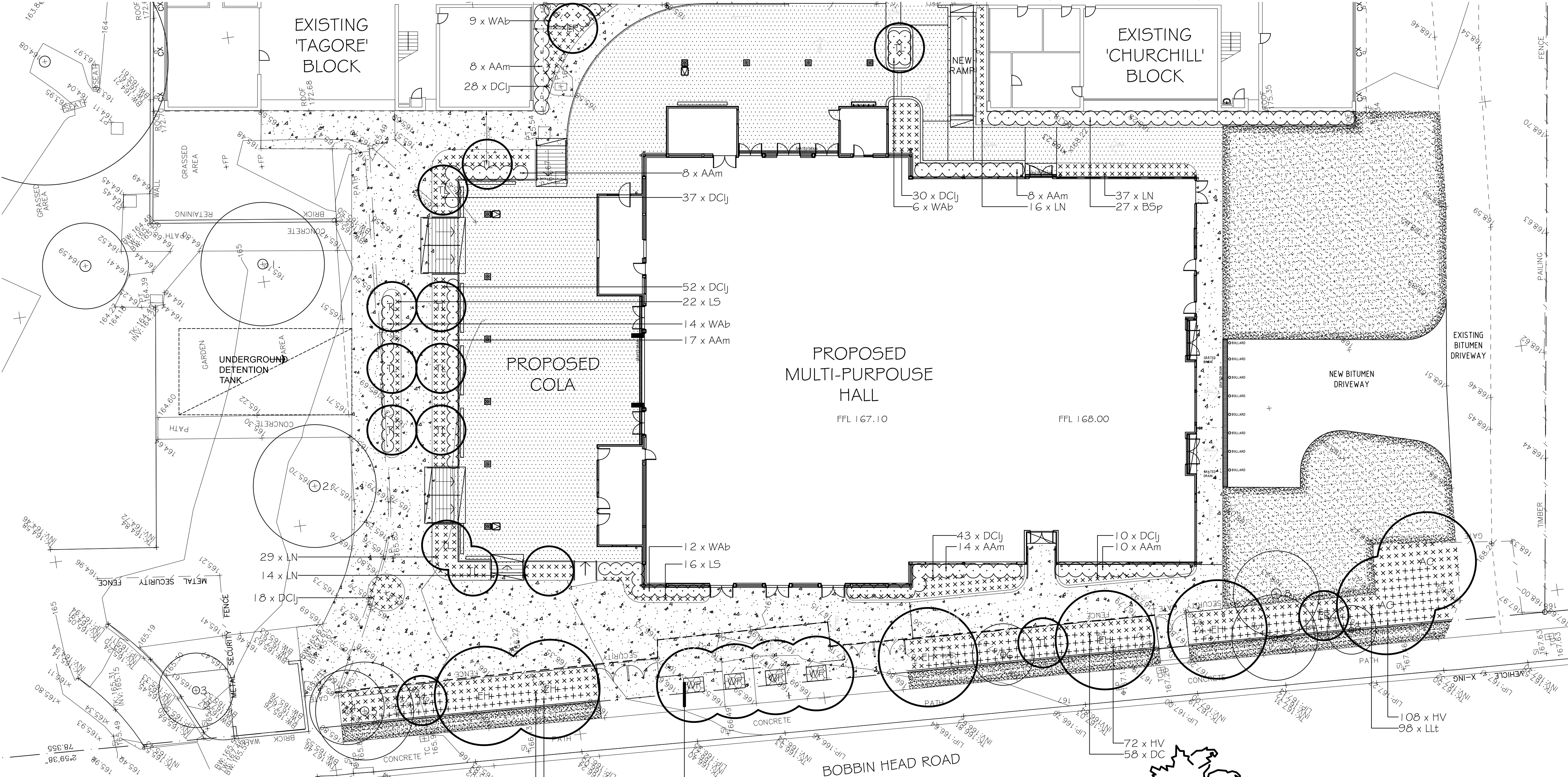

TREE GRATE FOR TREES ALONG FRONT BOUNDARY IN PAVED AREA

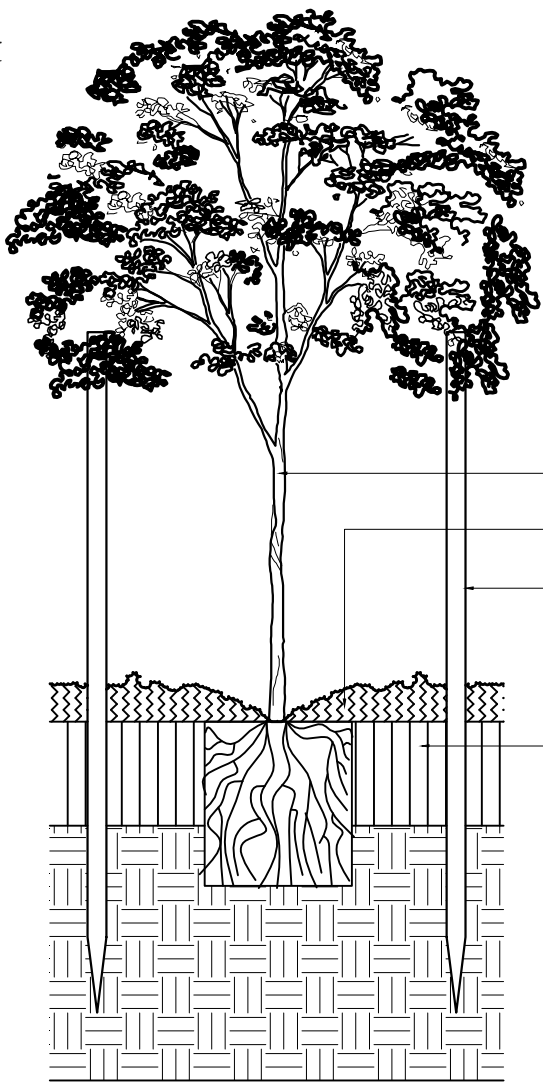

- Tree as specified.
- 100mm layer of mulch as specified.
- 4 off 50 x 50 x 1800mm Hardwood stakes spaced to form a 1m square with the tree stem centred between them.
- Refer to other details for garden bed preparation.

REVISIONS

A 22.01.19
1. Minor revisions to suit EFSG comments.

B 01.03.19

Revisions to suit Council comments:
1. Trees to be removed under DA0243/18 removed from plan.
2. Trees to be retained numbered as per Arborist report.
3. Seats in road reserve deleted.

1 BRICK GARDEN EDGING
SCALE 1:10
TYPICAL SECTION.

2 LAWN AREAS
SCALE 1:10
TYPICAL SECTION.

3 MASS PLANTING
SCALE 1:10
TYPICAL SECTION.

4 HARDWOOD STAKING FOR TREES
SCALE 1:20
TYPICAL SECTION.

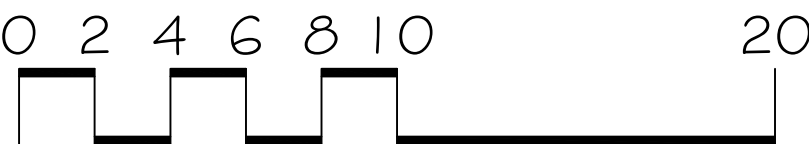

Ku-ring-gai High School

LANDSCAPE PLAN

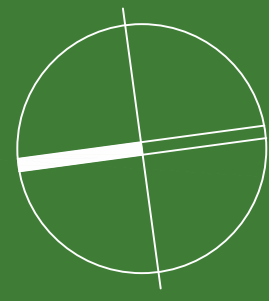

office. 16/303 pacific highway
lindfield nsw 2070
postal. 25 bent street
lindfield nsw 2070
ph 9416 4290 fax 9416 4735
A.C.N 097 328 580
email ijla@netspace.net.au

date
March 2019
job.dwg no.
88.19(18)/346'B'
designed by
IJ
scale
1:200 @ A1
1:400 @ A3
no. in set
ONE/ONE
drawn by
AM